

新築売戸建住宅

熊本市南区上ノ郷2丁目

新築 充実の標準仕様・設備と高い省エネ性能（ZEHレベル） オール

間取り

4SLDK

建物面積

102.68㎡

築年月

2024年12月



※現況優先

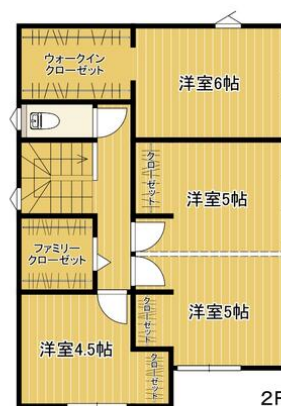

※現況優先

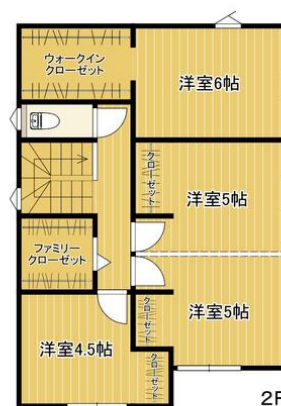

※現況優先

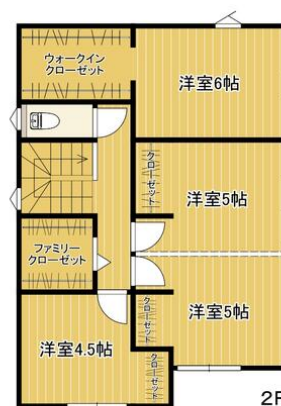

※現況優先

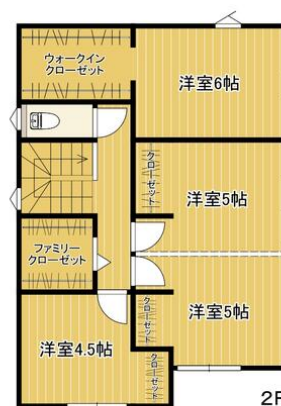

※現況優先

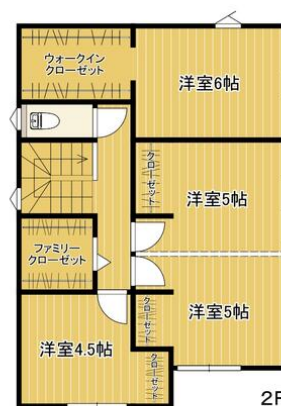

※現況優先

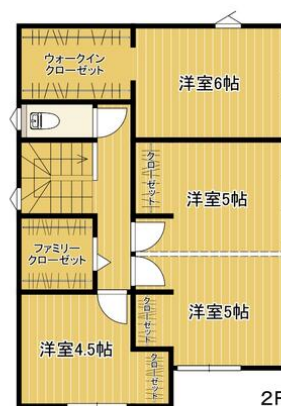

※現況優先

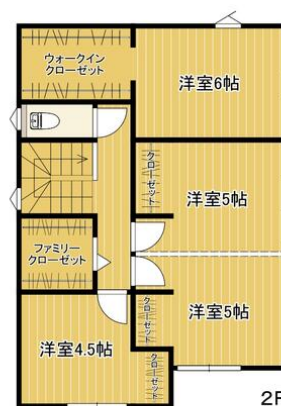

※現況優先

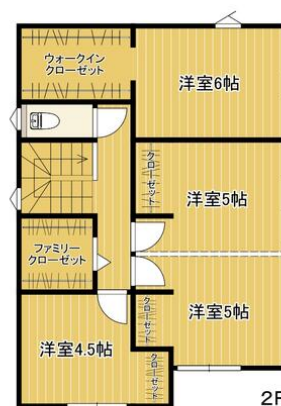

※現況優先

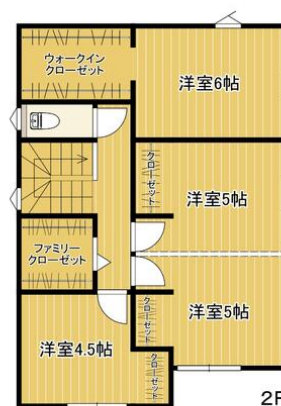

※現況優先

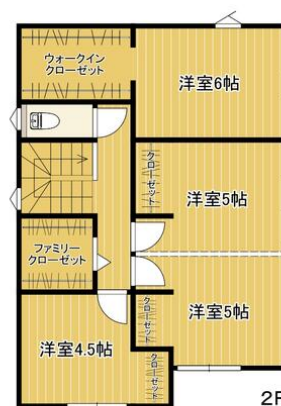

※現況優先

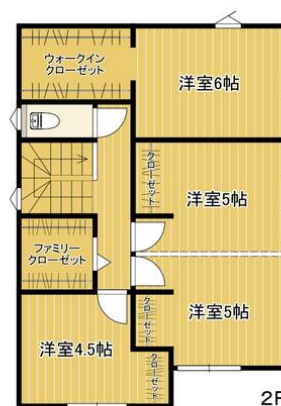

※現況優先

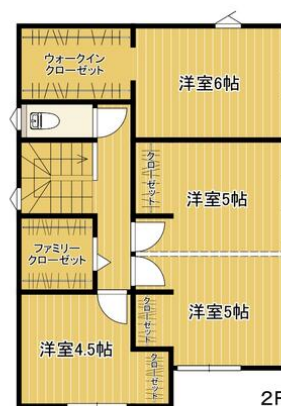

※現況優先

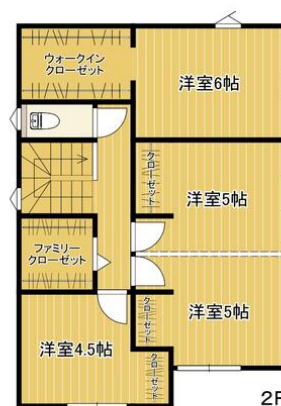

※現況優先

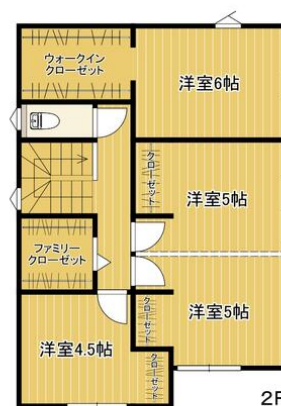

※現況優先

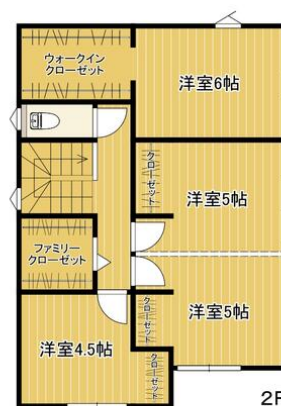

※現況優先

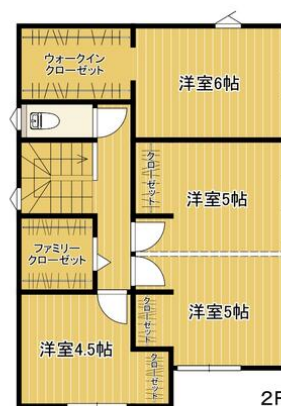

※現況優先

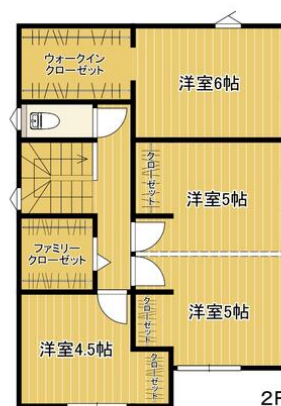

※現況優先

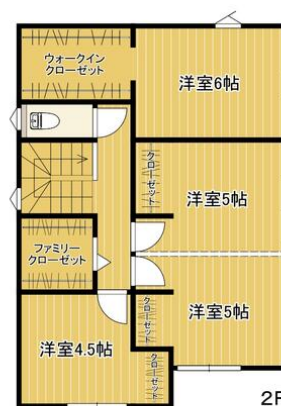

※現況優先

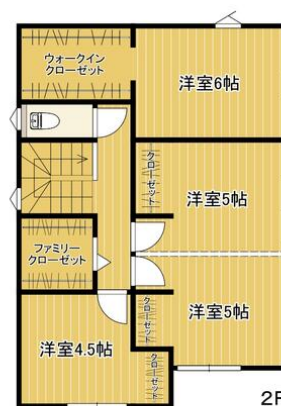

※現況優先

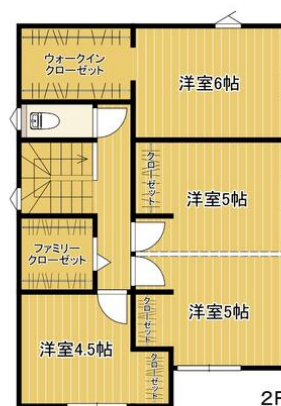

※現況優先

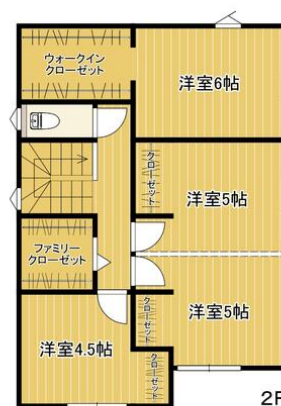

※現況優先

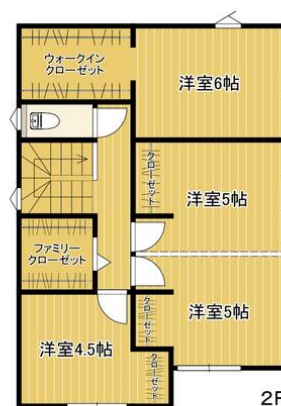

※現況優先

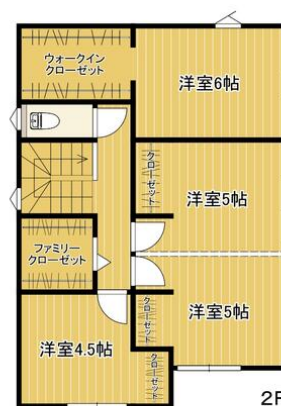

※現況優先

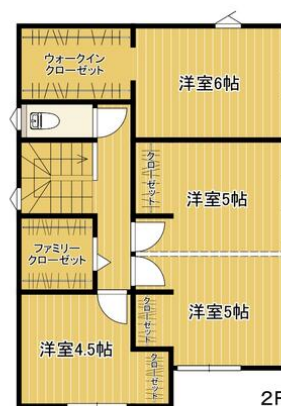

※現況優先

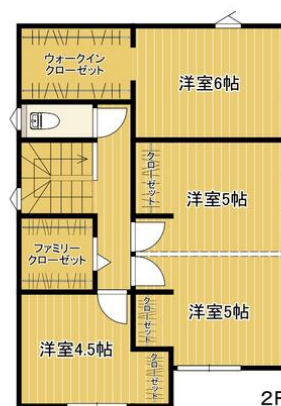

※現況優先

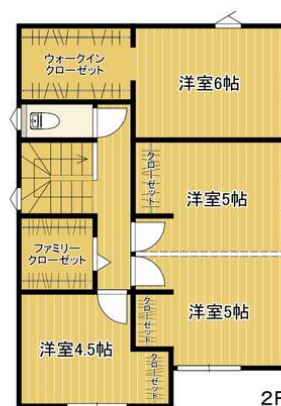

※現況優先

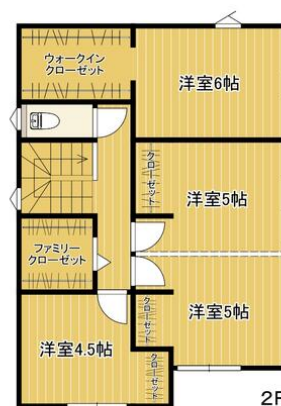

※現況優先

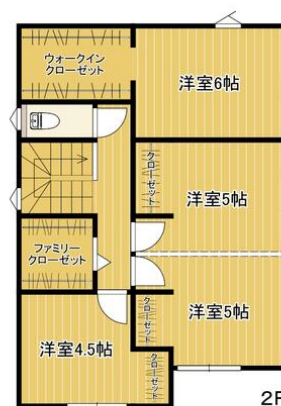

※現況優先

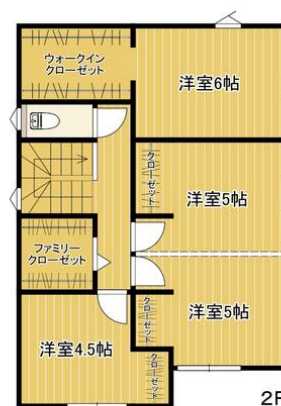

※現況優先

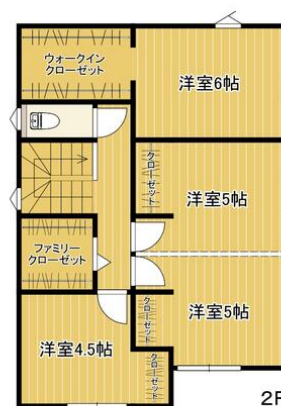

※現況優先

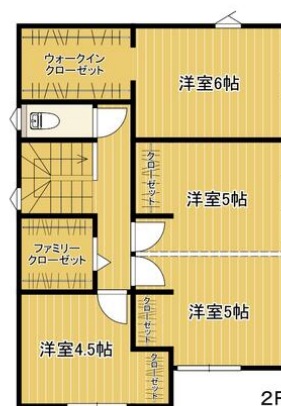

※現況優先

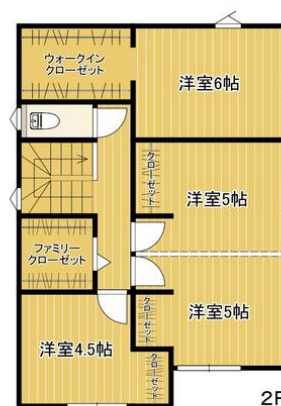

※現況優先

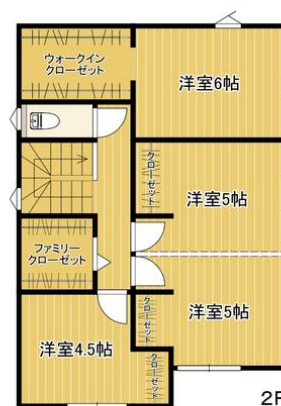

※現況優先

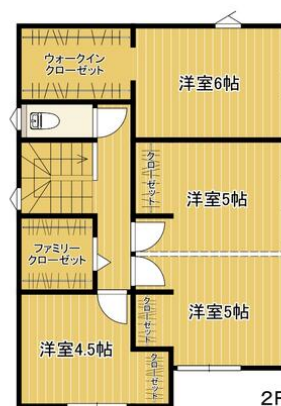

※現況優先

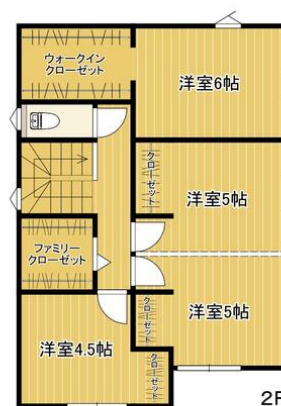

※現況優先

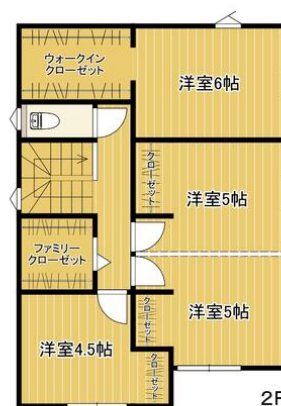

※現況優先

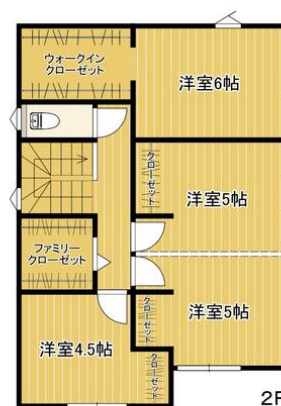

※現況優先

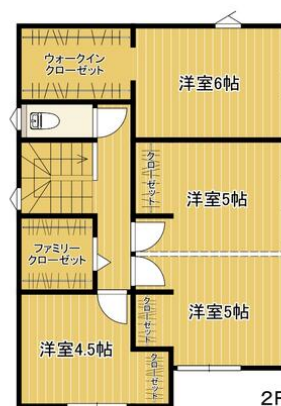

※現況優先

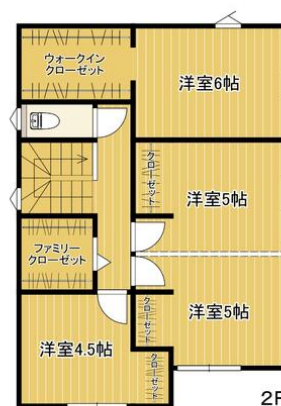

※現況優先

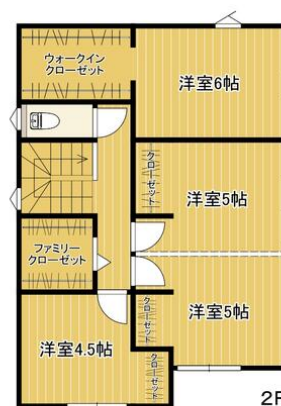

※現況優先

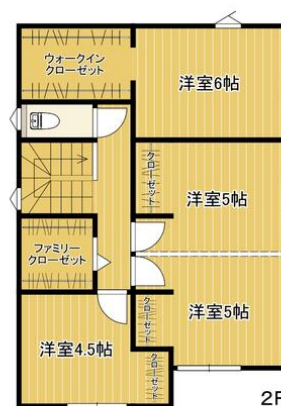

※現況優先

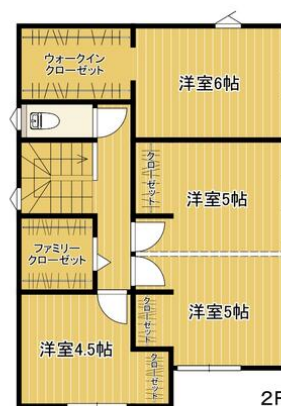

※現況優先

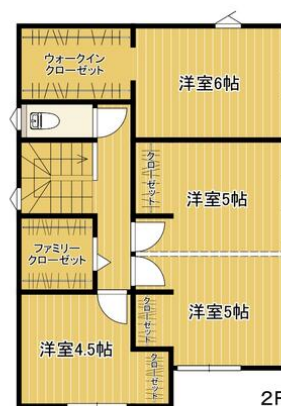

※現況優先

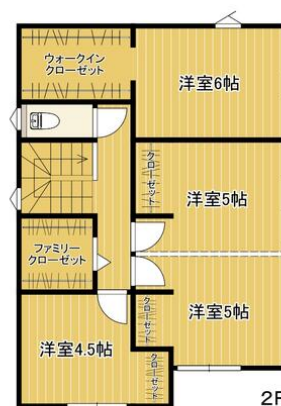

※現況優先

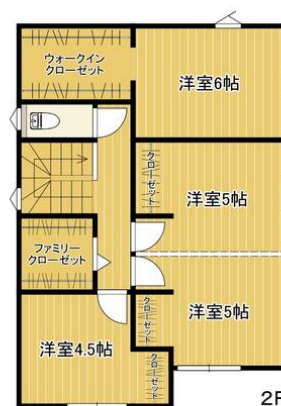

※現況優先

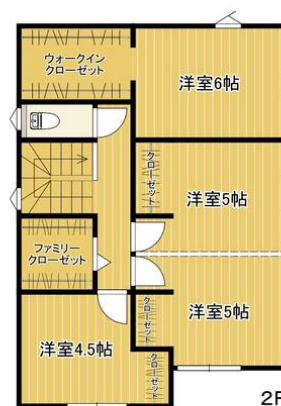

※現況優先

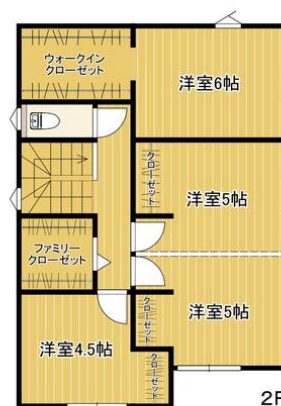

※現況優先

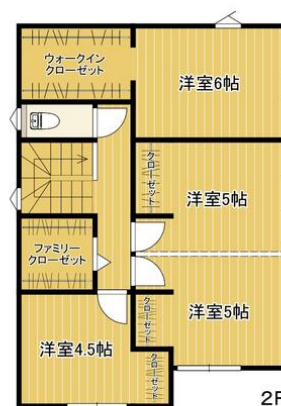

※現況優先

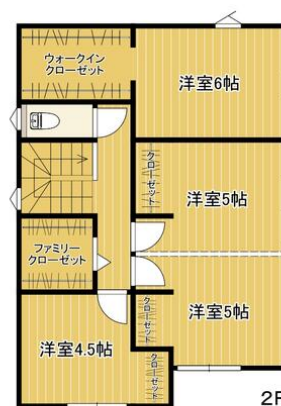

※現況優先

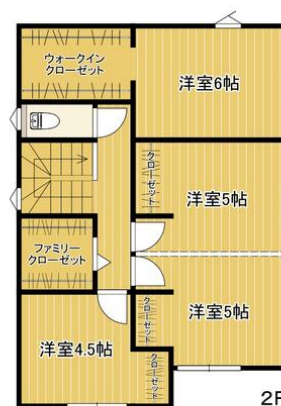

※現況優先

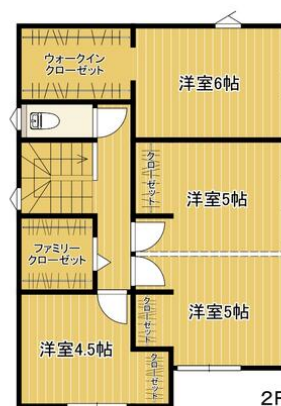

※現況優先

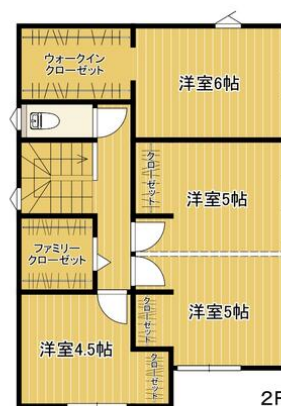

※現況優先

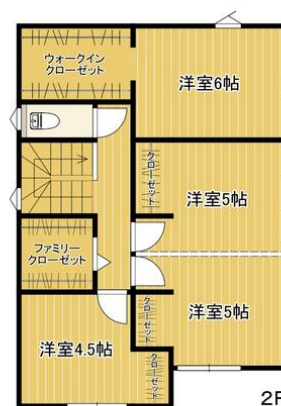

※現況優先

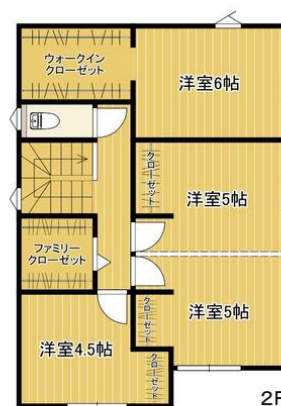

※現況優先

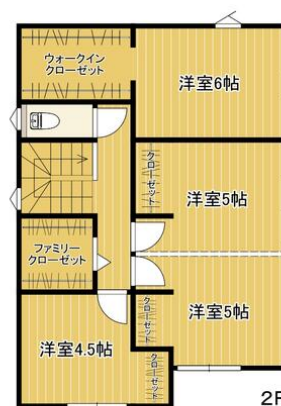

※現況優先

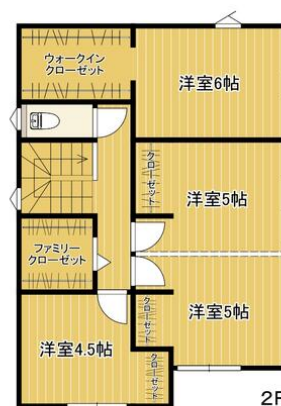

※現況優先

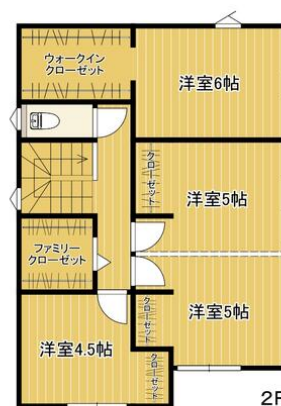

※現況優先

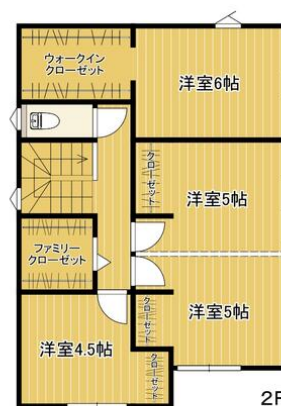

※現況優先



ナビ検索：熊本市南区上ノ郷2丁目2番5号付近

